

PITCHING DISASTER TENT 16.5 m2

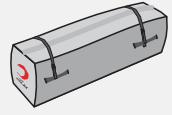

Contents of the Saddlebag Package



Tent Body (1pcs)



Frame Saddlebag (1 Piece)



Inner Liner (1pcs)



Pile Saddlebag (1 Piece)

Contents of the Frame Saddlebag



No	Explanation	Feature	Piece
1	Foot Pipe	194 cm	6
2	Roof Pipe	194 cm	6
3	Roof Pipe	155 cm	6

Contents of the Pile Saddlebag

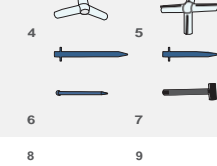

No	Explanation	Feature	Piece
4	Interconnection Apparatus	3 way	6
5	Interconnection Apparatus	4 way	3
6	T-Pile	40 cm	4
7	T-Pile	25 cm	4
8	Nail Pile	16x300 mm	6
9	Hammer	1,5 kg	1

1) FRAME INSTALLATION

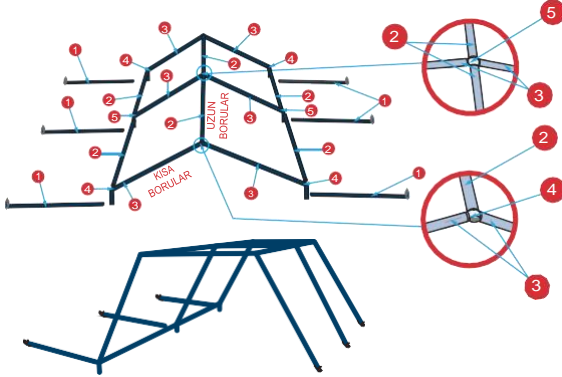

4) INSTALLING THE LINER

Make the hook connections of the tent inner liner starting from the top of the back of the tent frame. Attach the hooks in the line with the lining zipper to the middle of the frame.

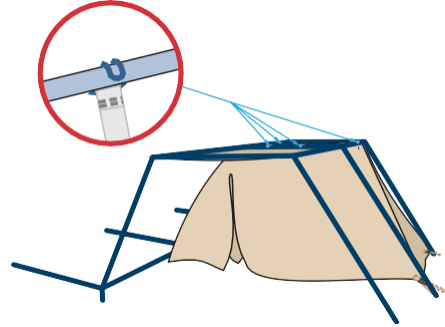

3) BODY ASSEMBLY

Dress the frame so that the tent body front door is flush with the lining front door.

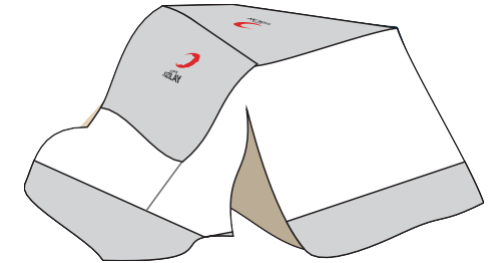

4) STRETCHING THE LINER

Attach the foot pipes on the other side of the tent. Perform the tensioning process by attaching the inner liner base tensioning hooks to the sheets on the feet. To tighten the liner base, drive 25 cm T-stakes into the rings on the base.

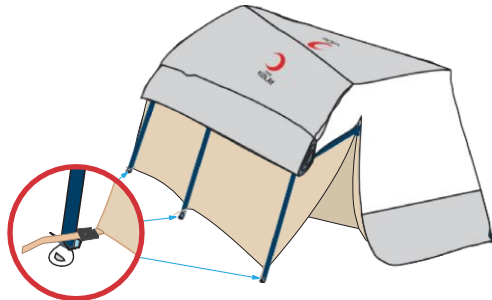

5) FIXING THE TENT

Close the front and rear tent zippers and align the foot pipes to the corners of the tent, then fix the feet to the ground with nail piles. For side tensioning, drive 40 cm T-stakes 1 m away from the tent, fix the tent by means of tent tension ropes.



5) FINAL CHECK

The tent has become ready for use.

